

# Tokyo Tama Mirai Messe

[Address] 3-19-2, Myojincho, Hachioji-city, Tokyo 192-0046

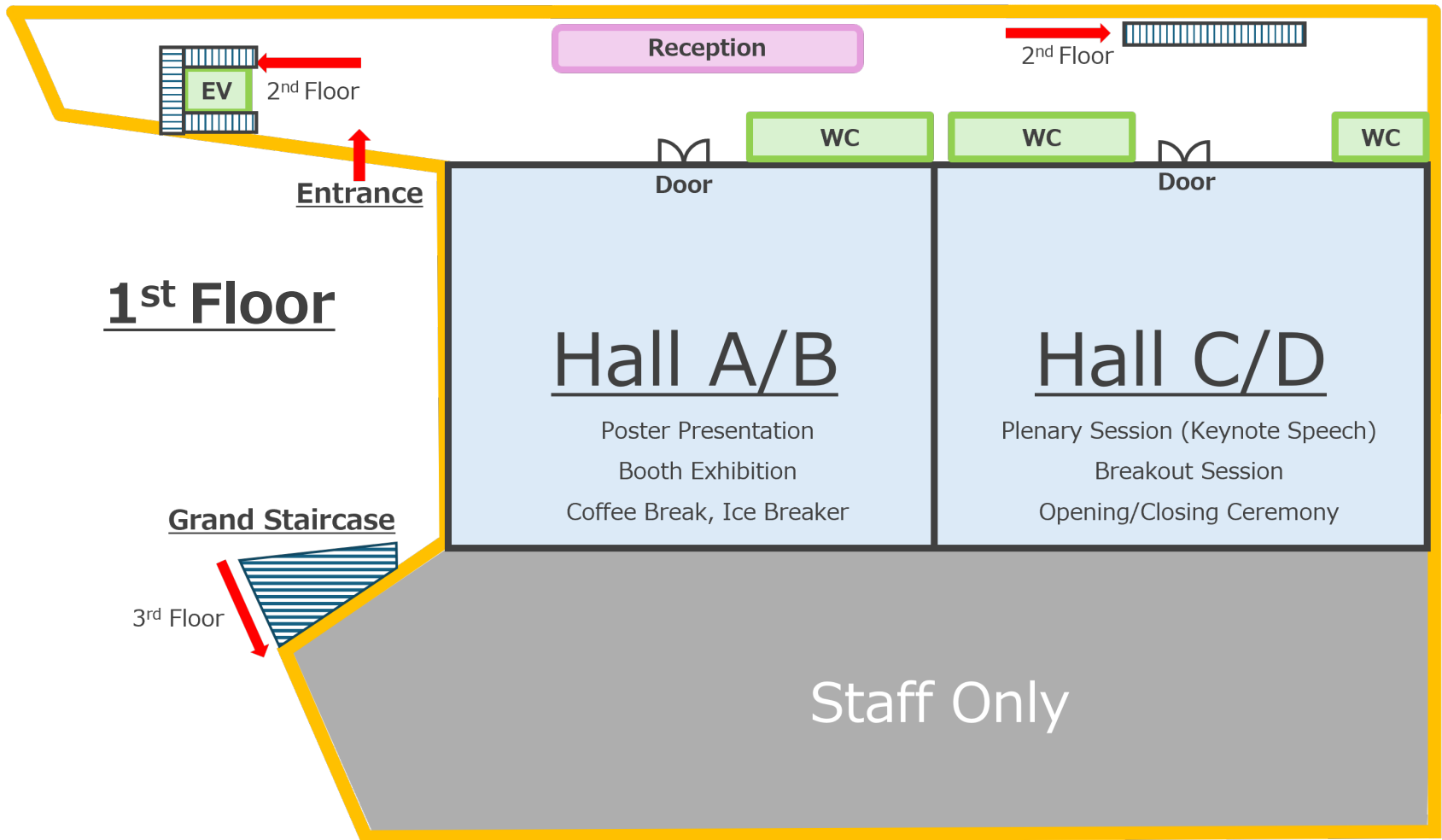

Hall C/D

- Smoking is prohibited in all areas of the venue.
- Please wear your name tag all time in the venue.
- No shops and vending machines at the venue.

| Keynote Speeches                                |  |
|---|--|
| <a href="#">October 28 (Tue)</a><br>11:00-11:45 | TBD  |
| <a href="#">October 29 (wed)</a><br>14:00-14:45 | <b>Dr. Anna Nikolopoulos</b><br>Senior Advisor / UiT The Arctic University of Norway   |
| <a href="#">October 30 (Thu)</a><br>14:30-15:15 | <b>Dr. Kristín Ingvarsdóttir</b><br>Associate Professor / School of Humanities, Faculty of Languages and Cultures, University of Iceland |
| <a href="#">October 31 (Fri)</a><br>9:30-10:15  | <b>Dr. Yoshihiro Iijima</b><br>Professor / Tokyo Metropolitan University   |

| Breakout Sessions                |        |
|----------------------------------|--------|
| <a href="#">October 28 (Tue)</a> | R2     |
| <a href="#">October 29 (Wed)</a> | R2, S2 |
| <a href="#">October 30 (Thu)</a> | S3, S4 |
| <a href="#">October 31 (Fri)</a> | R3     |

| Opening Ceremony       |   |
|------------------------|---|
| October 28 (Tue), 2025 |   |
| 10:00                  | Declaration of Opening by Chair of ISAR-8 LOC |
|                        | Welcome Speech by Organizers: TBD             |
|                        | Guest Speech: TBD                             |
| 10:35                  | Close, move to Entrance                       |
|                        | Photo Session                                 |
| 10:50                  | Photo Session ends                            |

| Closing Ceremony       |  |
|------------------------|--|
| October 31 (Fri), 2025 |  |
| 15:15                  | Closing Remarks: TBD   |
|                        | Poster Award Announcement and Closing Address from the Chair of ISAR-8 LOC |
| 16:15                  | Closing of ISAR-8  |

# Tokyo Tama Mirai Messe

[Address] 3-19-2, Myojincho, Hachioji-city, Tokyo 192-0046

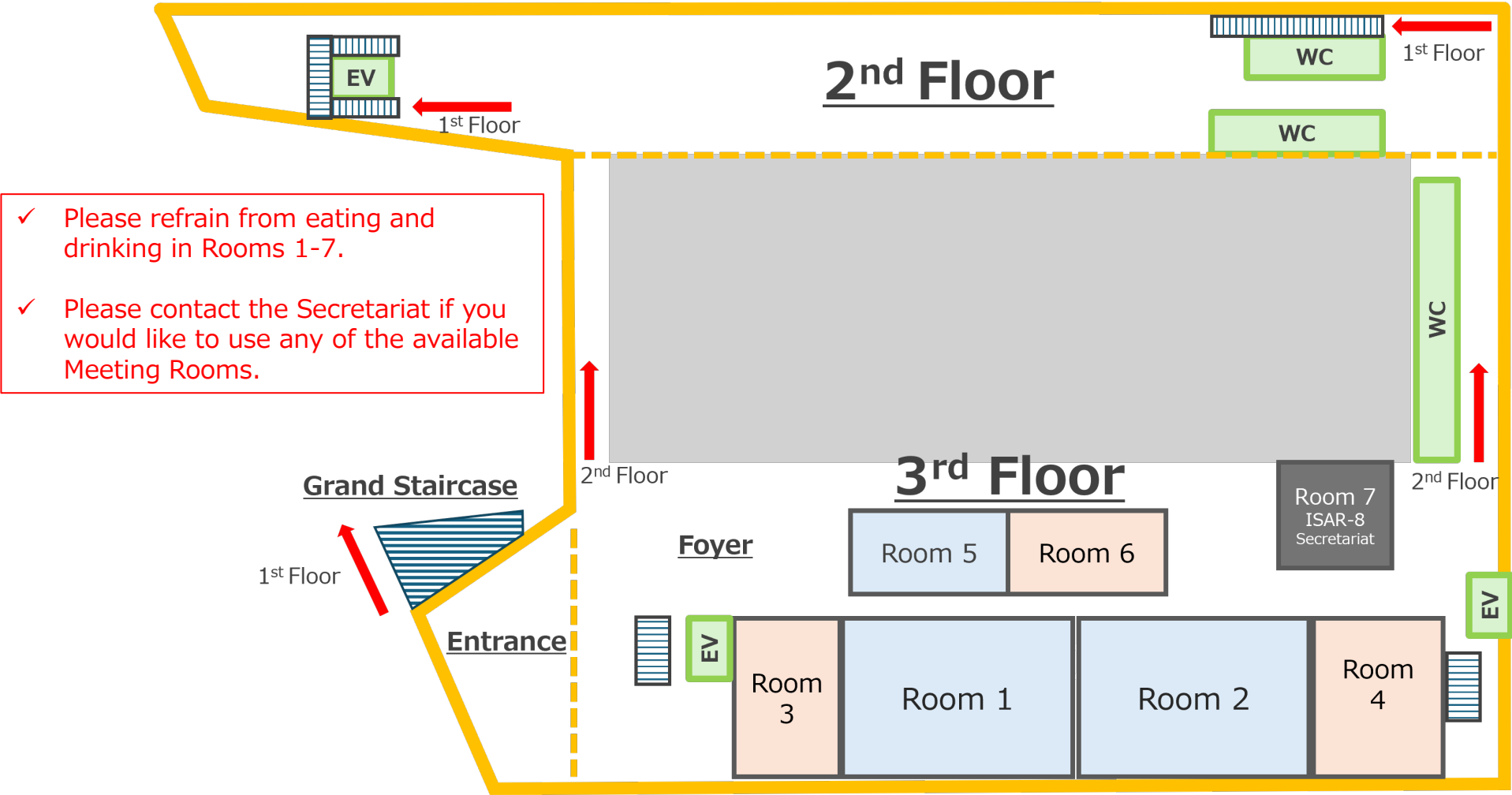

|                                   | Oct. 28 | Oct. 29     | Oct. 30    | Oct. 31  |
|-----------------------------------|---------|-------------|------------|----------|
| <u>Room 1</u><br>Breakout Session | S11+S12 | S8, S10     | S5+S6, S15 | R1       |
| <u>Room 2</u><br>Breakout Session | R7      | R10, R5, R4 | R8, R9     | R6       |
| <u>Room 5</u><br>Breakout Session |         | S13         |            | S17, S18 |

## Room 5 Side Meetings

**October 29 (Wed) 12:45-14:00**  
*Book Presentation: Arctic Policies of Non-Arctic States (Studies in Polar Law, Volume 4, Brill 2025)*

**October 30 (Thu) 18:45-20:15**  
*Synoptic Arctic Survey (SAS) Side Meeting*

# Tokyo Tama Mirai Messe

[Address] 3-19-2, Myojincho, Hachioji-city, Tokyo 192-0046

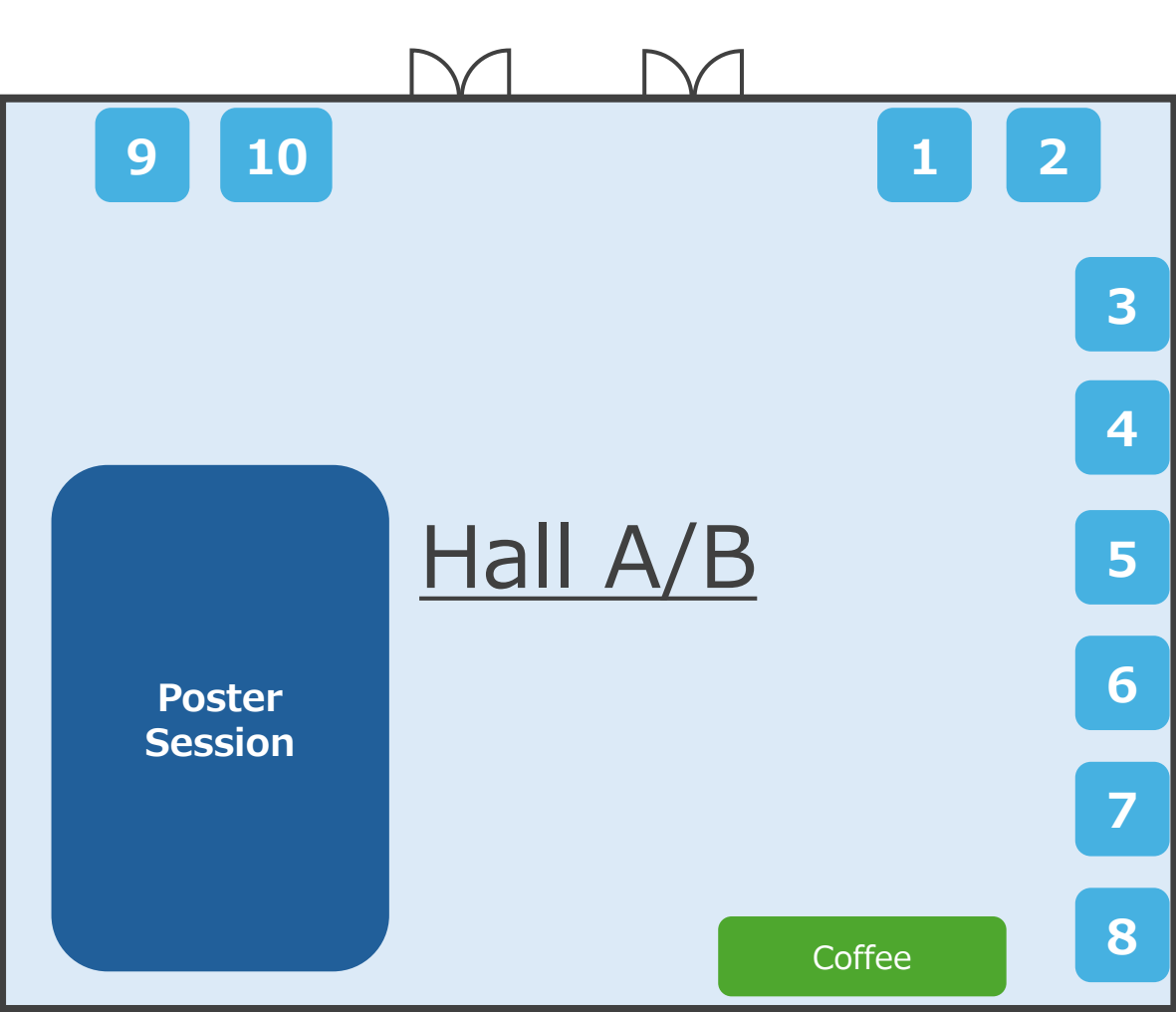

| Poster Session Core Time |                                 |  |
|--------------------------|---------------------------------|--|
| Core Time 1              | October 29 (Wed)<br>16:45-18:15 | R2, R4, R5, R7                           |
| Core Time 2              | October 30 (Thu)<br>15:30-17:00 | R1, R3, R6, R8, R10, S2, S3, S5, S6, S17 |

| Booth Exhibitions |  |
|-------------------|--|
| 1                 | EKO Instruments CO., LTD.  |
| 2                 | Cubic-i Ltd. (CLS JAPAN)   |
| 3                 | Campbell Scientific Japan, K.K   |
| 4                 | Arctic Challenge for Sustainability III (ArCS III)   |
| 5                 | Japan Agency for Marine-Earth Science and Technology (JAMSTEC)   |
| 6                 | Mitsui O.S.K. Lines, Ltd.  |
| 7                 | Arctic and Antarctic Data archive System (ADS) , NIPR  |
| 8                 | Fieldpro, Inc.   |
| 9                 | Prede Co., Ltd.  |
| 10                | Electronic Navigation Research Institute, National Institute of Maritime, Port and Aviation Technology |



Icebreaker will be held on October 28 (Tue) at 18:30.  
We hope you will join us!

